

How to Insert the Log in Box Element

"Log in" box allows you to connect the sale funnel to the membership site. You can also use it on any page which you want your customers to log in to your membership site. It could be the last page or the Thank you page of your "Sales Funnels".

Here's the instructions:

Step 1: Go to the page which you want to add the log in box.



Step 2: Drag the "Page Element" to the content area.

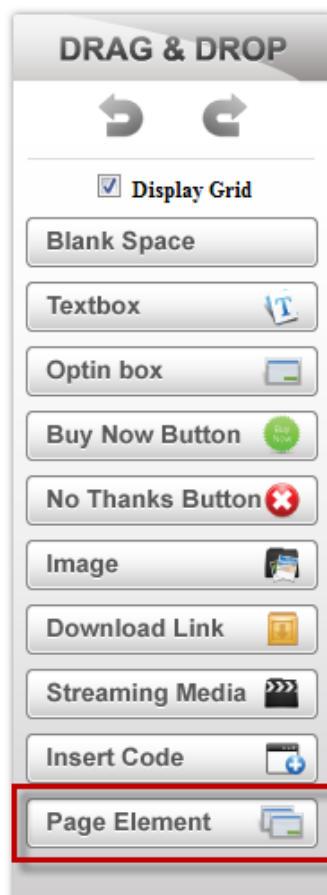

Step 3: Select "Add-ons".

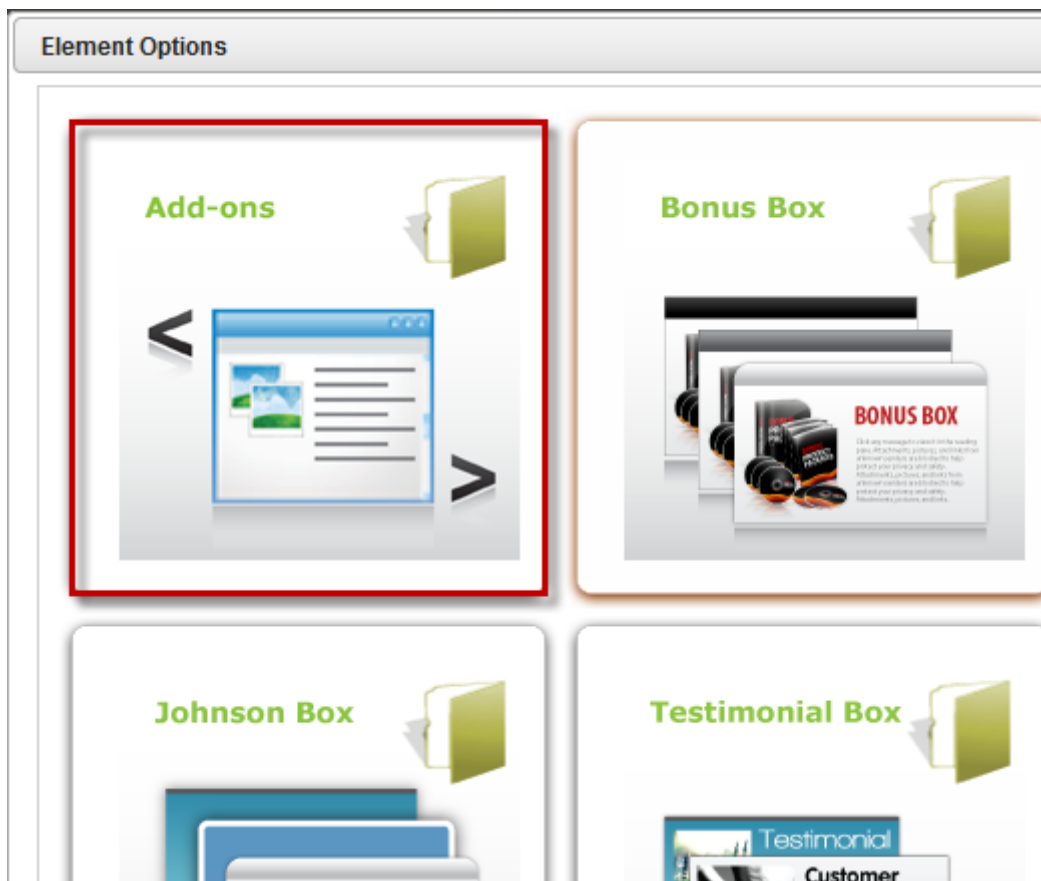

Step 4: Select "Custom Login Box".



Step 5: Select the membership site from the drop-down menu and click "**Apply**".

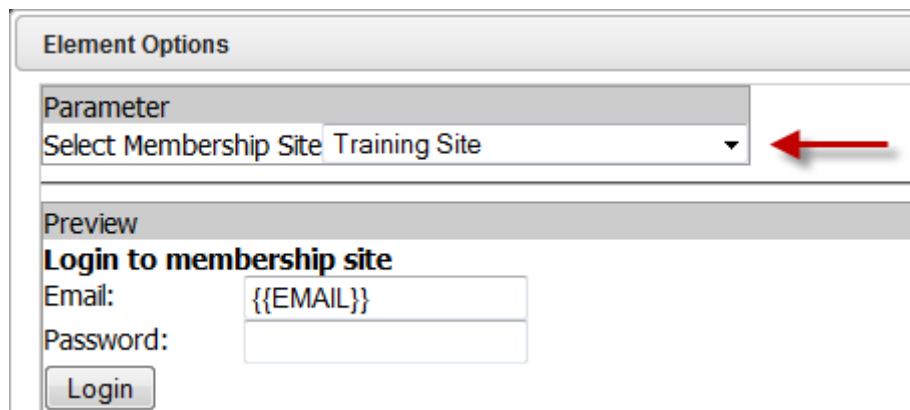

The image shows a configuration window titled "Element Options". Under the "Parameter" section, there is a dropdown menu with the text "Select Membership Site" and "Training Site". A red arrow points to the dropdown arrow. Below this is a "Preview" section with the heading "Login to membership site". It contains two input fields: "Email:" with the placeholder text "{{EMAIL}}" and "Password:". A "Login" button is located at the bottom left of the preview area.

You can customize the size and the location of the log in box element. Once finish, you can save the page and upload your website.